

# DASHBOARDS

WIN PROJECTS BY TAKING ADVANTAGE OF WORLD'S MOST PROMINENT  
USER-INTERFACE DESIGN

---

A Presentation by Works Software





OVERVIEW

## A MODERN USER INTERFACE

Win Projects by taking advantage of world's most prominent user-interface design.

---

Responsive Dashboards for Today's Customer where you can express your own brand. Built with the fastest web technologies, React, Redux, and Material UI. React will efficiently update and render just the right components when your data changes. Cross-Platform usage and responsive design using Google's Material Design Guidelines & Best Practices.

## DASHBOARDS

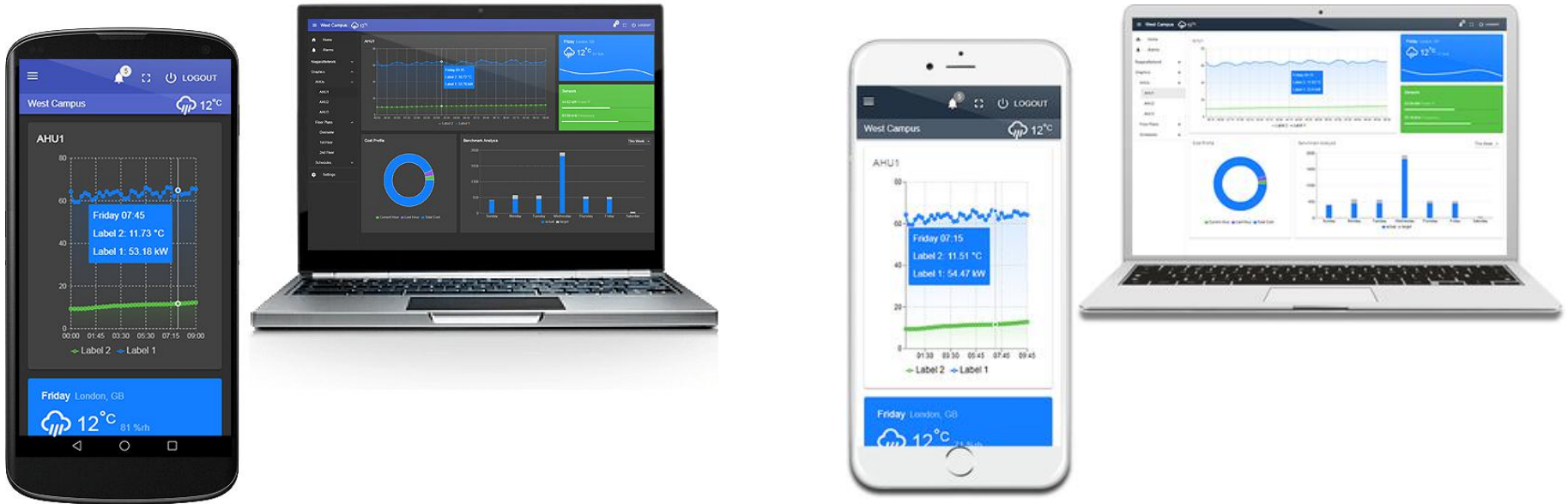

### THEMES

Switch between a Light and Dark theme. Not Enough? Go further and customise colors in the Advanced options.



### SMALL FOOTPRINT

No Installation Required. No External Services. Minified to less than 1mb. Just a few files to be copied to a directory of your choice. Allows interaction to be Super Fast.



### MULTI-LEVEL ACCESS

Only a super-user can modify the dashboard, while standard operators can see their views. Use as much or as little as you like.

A grayscale photograph of a business meeting. A woman with curly hair is on the left, looking at a laptop. A man with glasses and a beard is on the right, looking at a document. Other people are visible in the background.

## ALLOW CONSUMERS TO ACCESS DATA ANYWHERE 24/7/365



### LAPTOP

---

Best viewed in 1920  
x1080 resolution.  
Consumers receive real-  
time updates  
automatically



### MOBILE

---

Material UI Latest  
responsive design with  
mobile first architecture,  
built for speed



### TABLET

---

Templates have a light  
footprint, some as small  
as 55kb, allow for super-  
fast screen rendering



## PX VIEW

---

Includes a navigation menu, dark & light theme, multi-level access, and shows existing PX graphics



## ALARM VIEW

---

In addition to all the features of the PX View, the alarm view allows you to manage system alarms



## ENERGY

---

The energy consumption shows site analytic data gathered from device histories



## SCHEDULING

Scheduling View Template allows you to modify equipment schedules from anywhere.



## FLOOR VIEW

Floor Plan Zoning Template allows you to add polygon shapes over your existing images and display point values



## CUSTOM

If any template doesn't fit your needs, contact us with your requirements



# TECH-NO L-O-GY

---

Built with the latest HTML5 web  
technologies:

Facebook React-  
Material UI-  
Redux-

# DASHBOARD NAVIGATION

As the super-user you will go through your stations configuration and apply views to each asset. Additionally, set each asset to either show/hide on the navigation menu. When a user logs on only those assets will appear in the menu with their respective views.

The screenshot displays a dashboard interface with four tabs: GENERAL, NAVIGATION (selected), VIEWS, and ABOUT. The NAVIGATION tab is active, showing a search bar and a tree view of assets. The tree view includes 'NiagaraNetwork' and 'Graphics' (expanded). Under 'Graphics', there are sub-items: 'AHUs', 'Boilers', 'Chillers', 'Floor Plans', and 'Schedules'. The main content area shows a search bar and a list of assets. The asset 'AHU Schedule' is selected, and a dropdown menu for 'Display Name' is open, showing options: 'None', 'PX View', 'Energy Consumption View', and 'Scheduling View' (highlighted). A refresh icon is visible next to the 'Drivers' label.



# VIEW SETTINGS

Log into the station (as a super-user) and set up the view in the Settings section.

GENERAL

NAVIGATION

VIEWS

ABOUT

PX VIEW

ALARM VIEW

ENERGY CONSUMPTION VIEW

SCHEDULING VIEW

FLOOR PLAN ZONING VIEW

View Name

Energy Consumption View

Weather Ord

service:openWeatherService:OpenWeath

Power Usage Slot

Power

Power History Relativised Point

Power

Temperature History Point

history:/demoStation/Temp?period=today|

# CONTROL EQUIPMENT SCHEDULES

Modify equipment schedules from anywhere. Easily control your devices with this easy-to-use interface. Includes special event scheduling.



# MONITOR ALARMS

Station operator's can quickly acknowledge alarms in a user-friendly interface.

2 selected

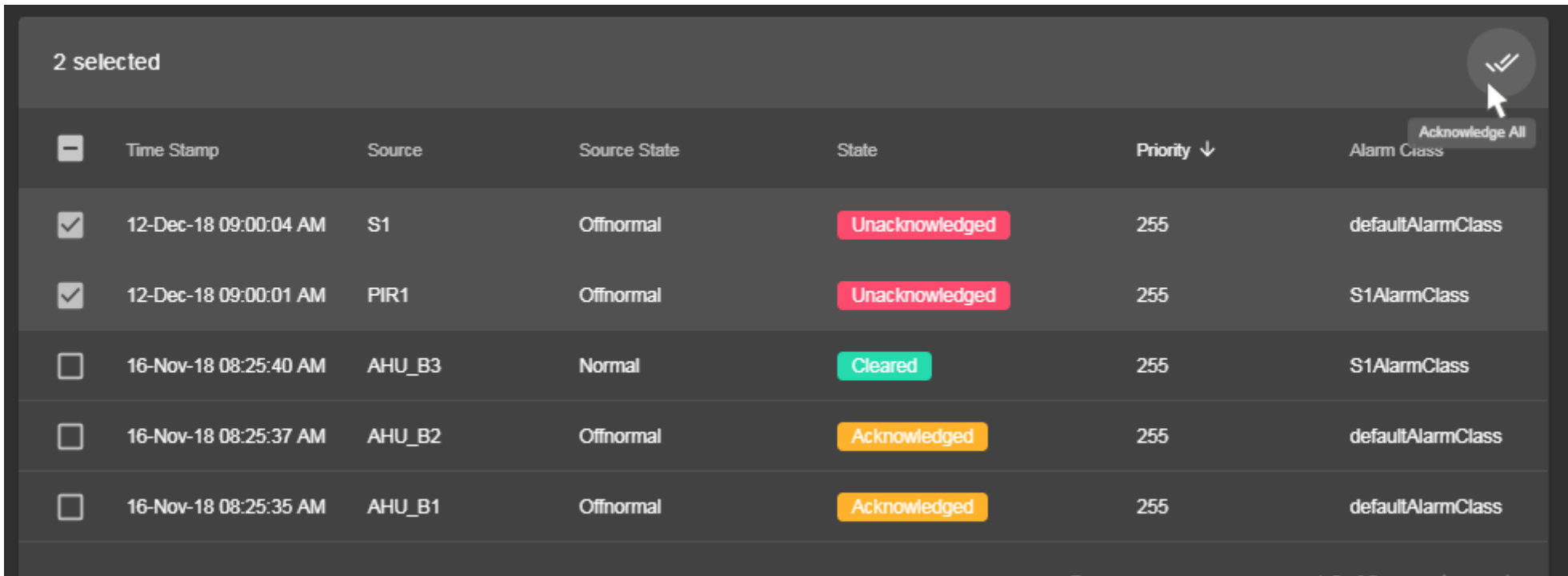

<input type="checkbox"/>	Time Stamp	Source	Source State	State	Priority ↓	Alarm Class
<input checked="" type="checkbox"/>	12-Dec-18 09:00:04 AM	S1	Offnormal	Unacknowledged	255	defaultAlarmClass
<input checked="" type="checkbox"/>	12-Dec-18 09:00:01 AM	PIR1	Offnormal	Unacknowledged	255	S1AlarmClass
<input type="checkbox"/>	16-Nov-18 08:25:40 AM	AHU_B3	Normal	Cleared	255	S1AlarmClass
<input type="checkbox"/>	16-Nov-18 08:25:37 AM	AHU_B2	Offnormal	Acknowledged	255	defaultAlarmClass
<input type="checkbox"/>	16-Nov-18 08:25:35 AM	AHU_B1	Offnormal	Acknowledged	255	defaultAlarmClass

# ENERGY CONSUMPTION

Show current energy consumption, power, cost, and weather with a 5-day forecast.

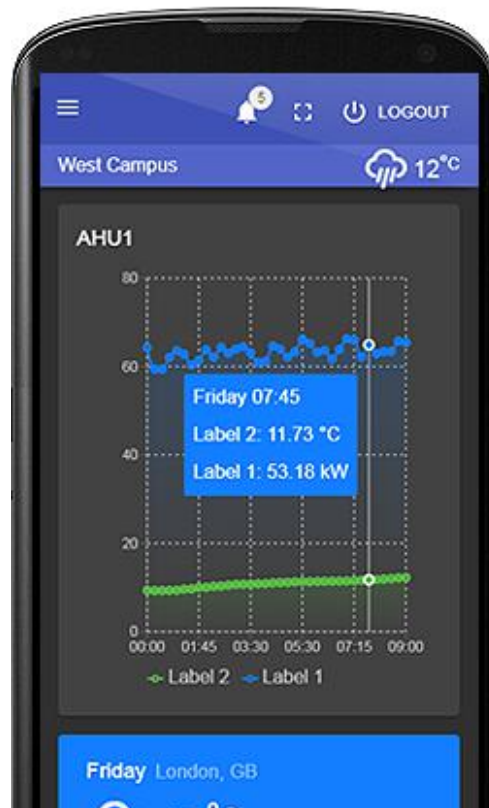

# FLOOR PLANS WITH ZONE & OCCUPANCY

Show values and occupancy data on floor plan images or navigate to other areas.

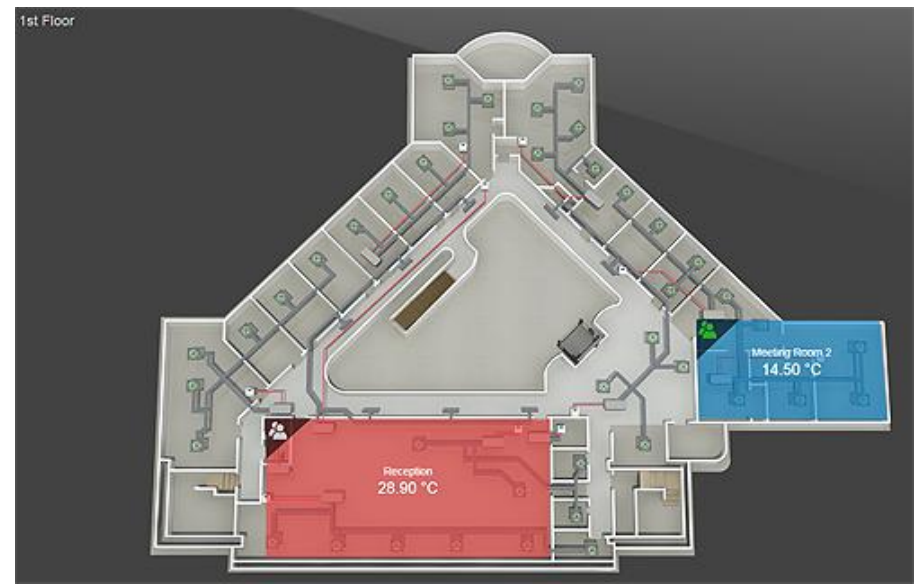
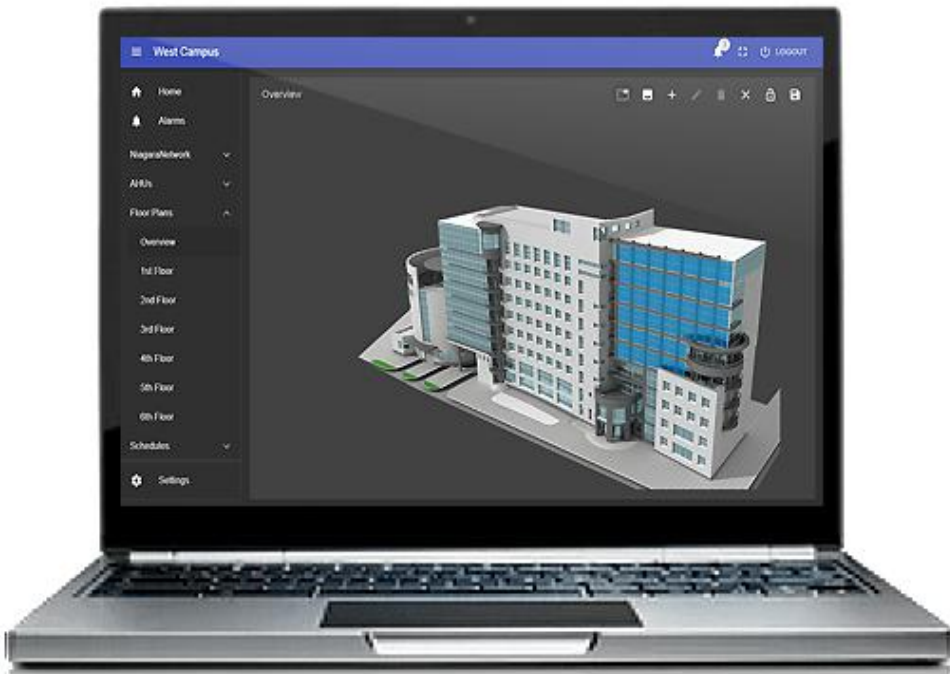

# USE EXISTING PX GRAPHICS

Keep your existing PX graphics with full functionality.

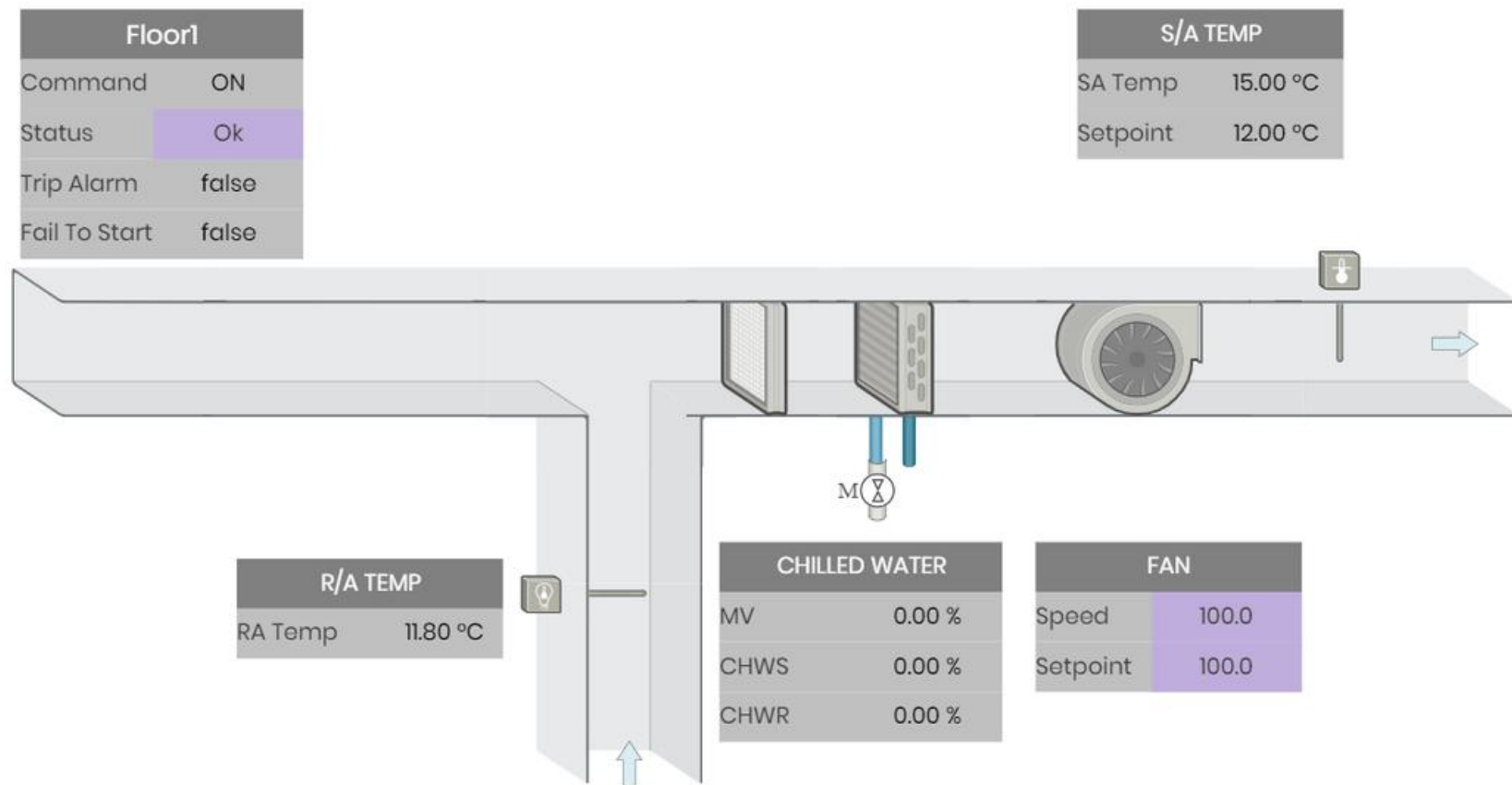

## UPCOMING DEVELOPMENTS

*PX View* - There are a number of developments in the pipeline for this view including the ability to build AHU/HVAC graphics using a symbol library provided by us. Animated graphics will also be provided.

*Alarm View* - Ability to color rows, prioritise records, sounds, adding notes, very similar to our Advanced Alarm Table.

*Energy Consumption* - There is a new feature underway at the moment which will show energy analytics and allow the user more control over the data they want to display.

*Floor Plan/Zone Occupancy* - This very powerful feature will shortly include the ability to show/hide different layers for all services including Fire Zones, HVAC, Security, etc.

*View Builder*- Create your own views by choosing graphs, gauges, tables, or other widgets into areas where you see fit.





WORKS SOFTWARE *integrate everything*

We are a software development and integration company specialising in integrating different types of systems, technologies, and developing software solutions. Our software solutions are being used by some of the largest companies in the world across 30 countries, including, AT&T, US Engineering, Honeywell, General Motors, Trend, General Dynamics and our Tridium partners.

<https://www.works-software.com>